

ACCESS 100 AC

Woofer (4")



- Cone DFS®
- ABS basket
- TN43 inverted dome tweeter

SPECIFICATIONS

Nominal power	40W	
Maximum power	80W	
Sensitivity (2,83V/1m)	87.2dB	
Cone	Glass fiber	
Surround	Butyl	
Nom. impedance	4 Ohms	
DC resistance	3.4 Ohms	
VC diameter	25mm	1"
VC height	10mm	0 ^{3/8} "
Former	Kapton	
Layers	2	
Wire	Copper	
Inductance	-	
Xmax	± 2.5mm	0 ^{1/8} "
Magnet d x h	72mm x 15mm	2 ^{13/16} x 0 ^{9/16} "
Magnet weight	160g	0.32 lbs
Flux density	0.9T	
Gap height	6mm	0 ^{1/4} "
Net weight	0.6kg	1.2 lbs

FREQUENCY RESPONSE/IMPEDANCE

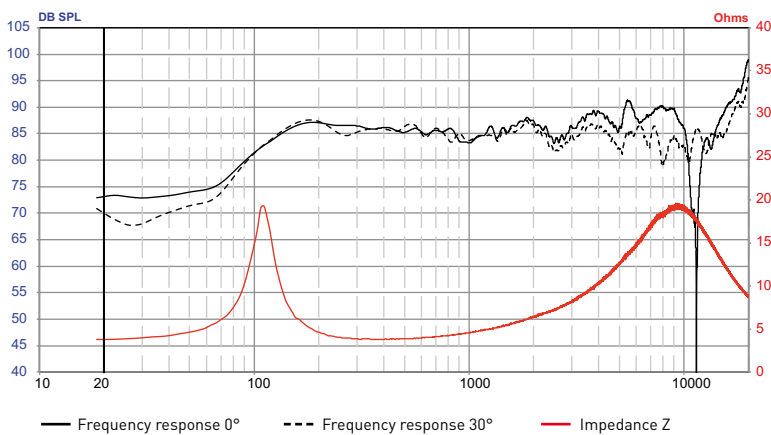

PARAMETERS

Fs	110.12Hz
Vas	1.07 liters
Qts	0.824
Qes	0.96
Qms	5.82
Re	3.4 Ohms
Sd	52.81cm ²
Cas	7.6E-09 m ⁵ /N
Mas	275.02kg/m ⁴
Ras	32695,15 Ohms.ac
Cms	272µm/N
Mms	7.7g
Rms	0.912kg/s
Ces	406.88mF
Les	5.13mH
Res	20.67 Ohms
BI	4.34N/A
SPL	83.5 dB/W/m

MECHANICAL DRAWING

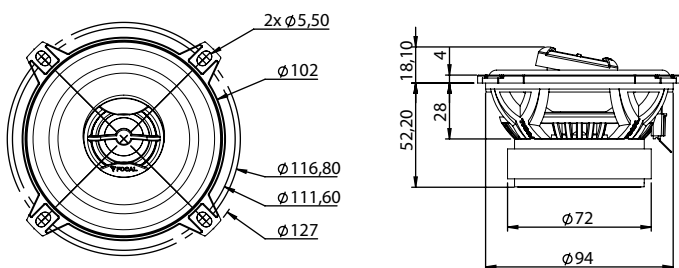

Performance
CREATE YOUR SOUND

FOCAL
THE SPIRIT OF SOUND